



*Calaveras County*  
*Environmental Management Agency*  
*Onsite Sewage Department*

---

---

## Plot Plan Requirements

1. Scale: Plan Size
  - a. Minimum 18" X 24" sheets
  - b. Scale is 1" = 10' for parcels  $\frac{3}{4}$  acre or smaller
  - c. Scale is 1" = 20' for parcels over  $\frac{3}{4}$  acre
  - d. For very large parcels, it is helpful to show the entire parcel at a smaller scale and show the developed area at 1" = 10' or 1" = 20'
  
2. Required Information
  - a. Owner's name, mailing address, phone #
  - b. Assessor's parcel number & recorded parcel map (if applicable)
  - c. Parcel address
  - d. North arrow & scale
  - e. Contractor's name, address, and phone # (if applicable)
  - f. Property boundary lines w/distances, bearing (if known), indicate if property corner pins have been found. Note: prior to any inspections, county stall will need you to have corners marked for easy identification.
  - g. Recorded easements
  - h. Setbacks per zoning code
  - i. Edge of pavement of the road upon which you would like to attach the new driveway (encroachment)
  - j. Driveway showing slope
  - k. Existing topography shown by contour lines.
  - l. Existing natural features: rivers, streams, ponds, seasonal drainage coursed, large trees, rock outcroppings
  - m. Existing human made features: buildings, culverts, cutbanks, roadside drainage ditches utilities, wells showing 100' radius
  
3. Proposed development:
  - a. Footprint of house, additions, decks
  - b. Driveways, turnarounds, turnouts
  - c. Water tanks
  - d. Septic system & expansion area
  - e. Finish contours
  - f. Finish drainage

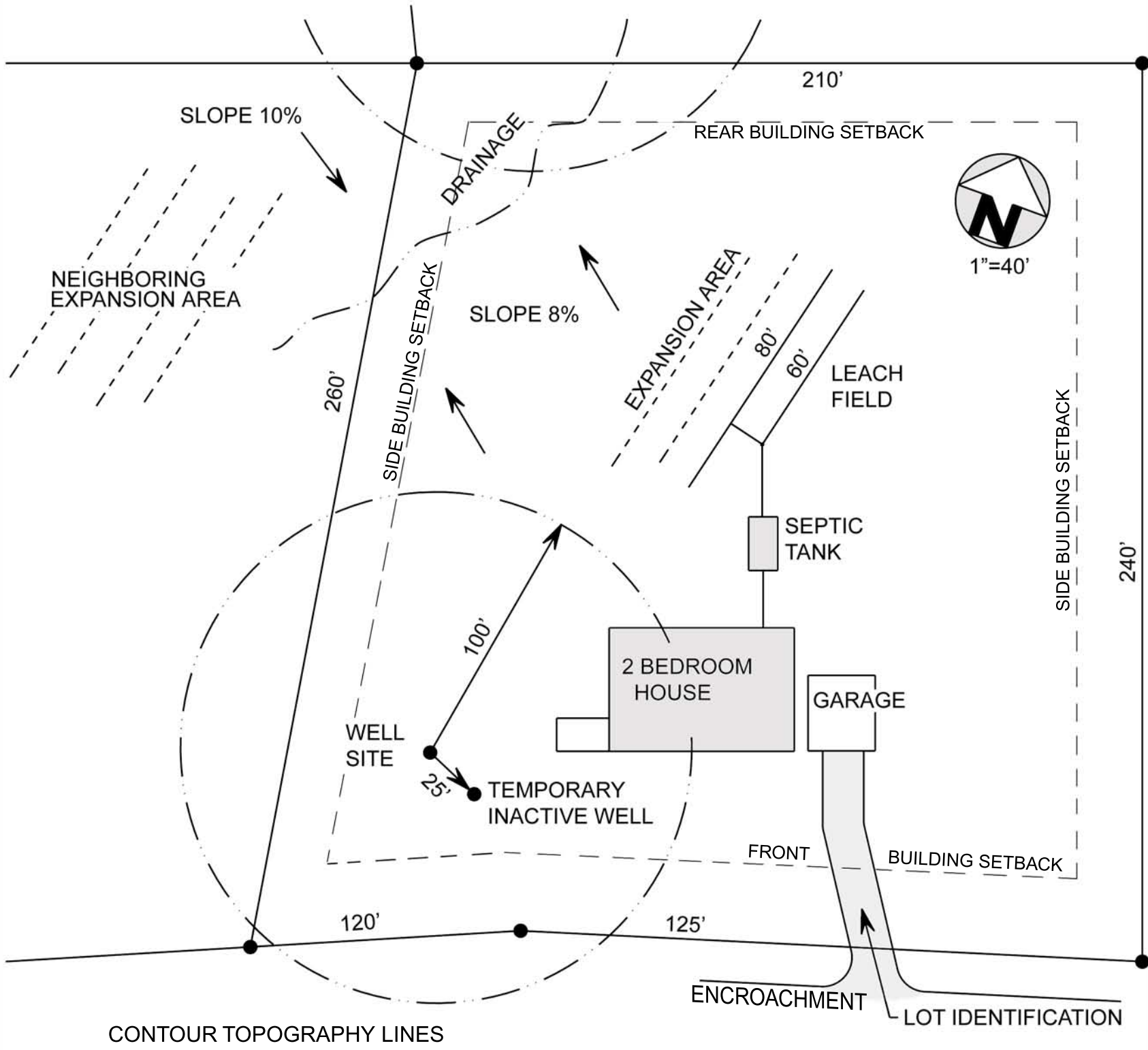

APN Number \_\_\_\_\_

Lot Number \_\_\_\_\_

Owner's Name \_\_\_\_\_

**SAMPLE**

**PLOT PLAN**